

DOOR SPECIFICATION

Steel doorsets **DFM DS** feature innovative design and robust construction. Door leaf of DFM EW 180 / EI , 90 is constructed of double panel made of rockwool and mineral slabs and corresponding double rebated door frame filled in with mineral slabs. Total thickness of door leaf is 112mm.

DOOR SIZES

Maximum frame external dimensions:

- width: 1195 mm
- height: 2379 mm

TECHNICAL PARAMETERS:

Fire resistance class: EW 180 / EI , 90

STANDARD EQUIPMENT

Standard equipment:

- Mortise latch and bolt lock,
- Set of stainless steel U-form handles on long shields,
- DIN eurocylinder and 3 standard keys,
- 3 or 4 pcs of stainless steel 3D hinges,
- 1 pcs of safety pin,
- Fire resistant intumescent gasket and rubber gasket,
- Powder coating to RAL,
- Alternative equipment and other door features on request.

CERTIFICATE

Classification Report - 03510/18/Z00NZP

Test Report - Lzp01 - 1559/18/Z00NZP

DRAWINGS

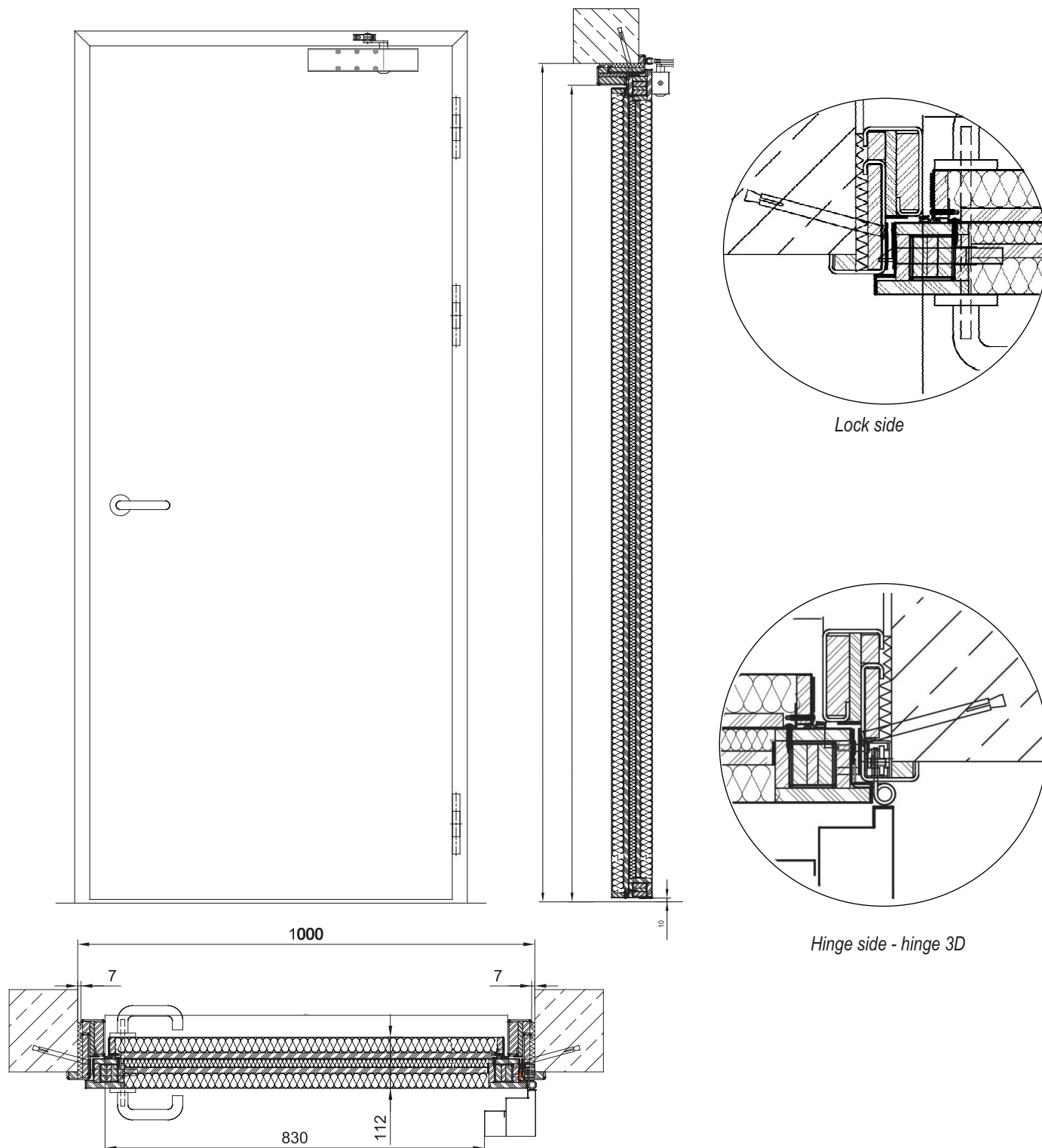

DOOR SPECIFICATION

Steel doorsets **DFM DS** feature innovative design and robust construction. Door leaf of DFM EW 180 / EI , 90 is constructed of double panel made of rockwool and mineral slabs and corresponding double rebated door frame filled in with mineral slabs. Total thickness of door leaf is 112mm.

DOOR SIZES

Maximum frame external dimensions:

- width: 1195 mm
- height: 2379 mm

TECHNICAL PARAMETERS:

Fire resistance class: EW 180 / EI , 90

STANDARD EQUIPMENT

Standard equipment:

- Mortise latch and bolt lock,
- Set of stainless steel U-form handles on long shields,
- DIN eurocylinder and 3 standard keys,
- 3 or 4 pcs of stainless steel 3D hinges,
- 1 pcs of safety pin,
- Fire resistant intumescent gasket and rubber gasket,
- Powder coating to RAL,
- Alternative equipment and other door features on request.

CERTIFICATE

Classification Report - 03510/18/Z00NZP

Test Report - L郑01 - 1559/18/Z00NZP

DRAWINGS

