



INSTALLATION MANUAL OF DOORS TYPE
DFM DS 120-1 AND DFM DS 120-2

with fire resistant range EI₁60 and EI₂120

v. EN 1.5.2020 CE/class. report No. 421/DFM-Door/2018/K/3

Our business model shall guarantee:

FACILITY – comfortable and customised solutions aimed at Customers' needs

TRANSPARENCY- clear business relations

BUSINESS EXPERTISE – a team of passionate professionals with “out of box ” attitude

1 IDENTIFICATION, HANDOVER AND NOMENCLATURE



During installation, usage and repair works prescriptions of safety on site must be observed, specifically those referring to particular regulations for construction and joinery works.

Installation must be carried out by qualified installers, trained for installation of fire doors.
Parts and components of doors shall not be modified or replaced.



e.g: DFM DS.120-2: DS = steel door, 120 = EI₂120 and EI₁60, 2 = double leaf door

During handover of goods from transport company check packaging and quantity of doors and cartons. In case of any claim a note CMR must be made and photos taken and sent to: it@dfm-europe.eu

ORDER

PROJECT NAME: „SOHO
X.199808”
PROJECT DOOR NUMBER:
„74”

PACKING LIST

PROJECT NAME: „SOHO
X.199808”
PROJECT DOOR NUMBER: „174”
INDIVIDUAL PRODUCTION
DOOR NUMBER: 1087/2020/026

LABEL ON THE CARTON WITH EQUIPMENT

PROJECT NAME: „SOHO X.199808”
INDIVIDUAL PRODUCTION DOOR
NUMBER:1087/2020/026
QUANTITY AND NUMBER OF CARTON:
1/3

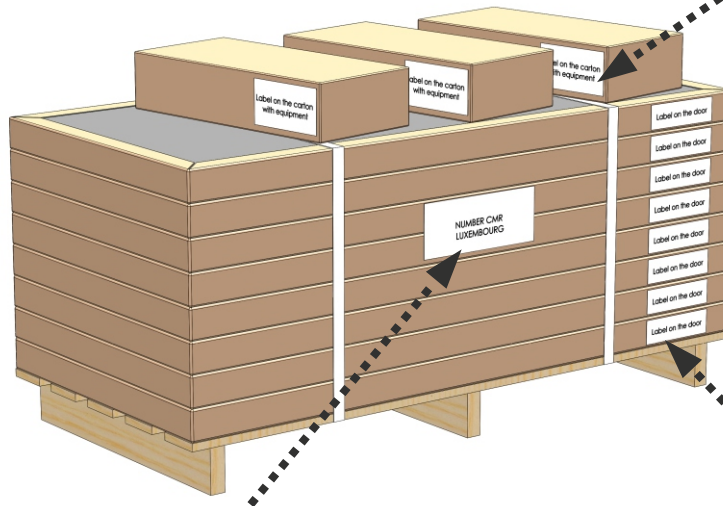

CMR

INDIVIDUAL PRODUCTION DOOR
NUMBER:
1087/2020
1345/2020
1589/2020

LABEL ON THE DOOR

PROJECT NAME: „SOHO X.199808”
PROJECT DOOR NUMBER: „74”
INDIVIDUAL PRODUCTION DOOR
NUMBER: 1660/2020/021

ADDITIONAL INFORMATION ON PALLET SIDE :
NUMBER OF CMR: „573”
DELIVERY ADRES: "LUXEMBOURG"

Example of labels on the door and box with equipment:

| | |
|---|-------------------|
| DFM DS-30-1-OB. | DFM |
| Nr zlecenia / Production Nr. | DOORS |
| 01087/2020/026 | |
| 1000 x 2130 P | |
| Oznaczenie projektowe / Project Name | |
| 74 Project : SOHO X.199808 | |
| Data Produkcji / Prod Date : 2020-07-16 | Kolor 8019 satyna |

| | |
|---|------------|
| DFM DS | DFM |
| Nr zlecenia / Production Nr. | DOORS |
| 01087-EU-2020 | |
| PACZKI / EQUIPMENT | 1/1 |
| Oznaczenie projektowe / Project Name | |
| 74 Project : SOHO X.199808 | |
| Data Produkcji / Prod Date : 2020-07-16 | |

DIN LEFT

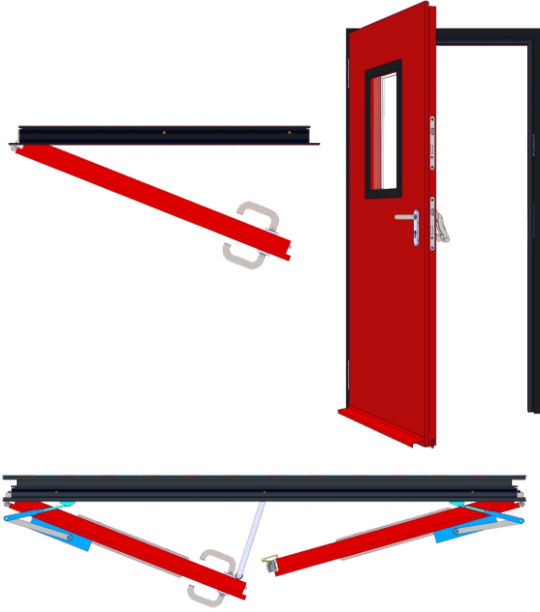

DIN RIGHT

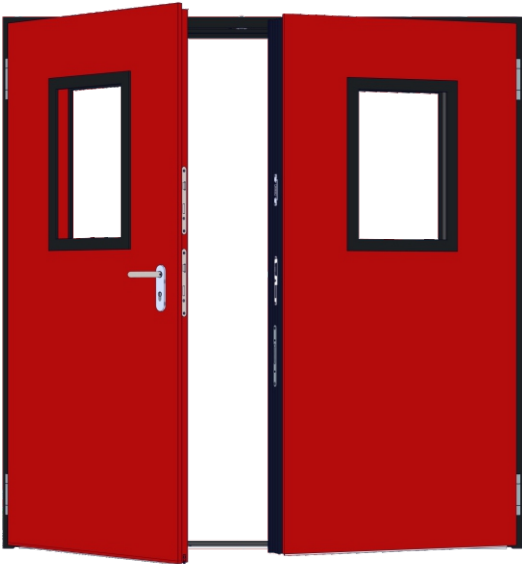
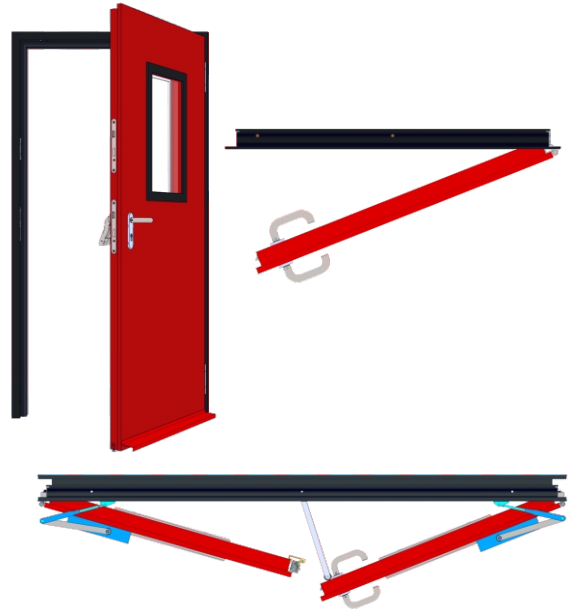

2 CHECK THE WALL OPENING

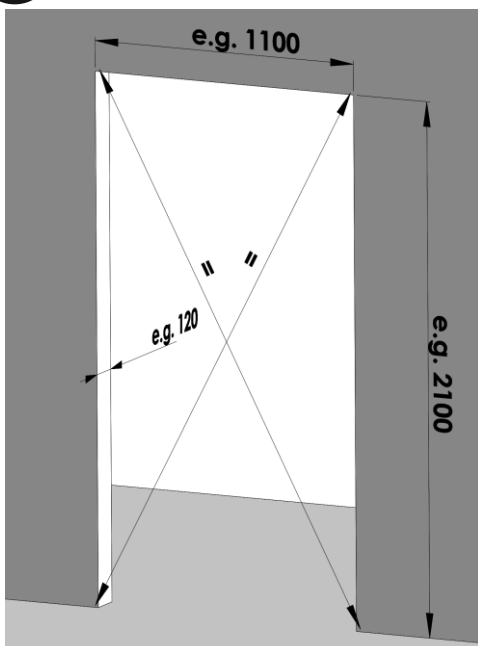

IS IT FINAL FLOOR?

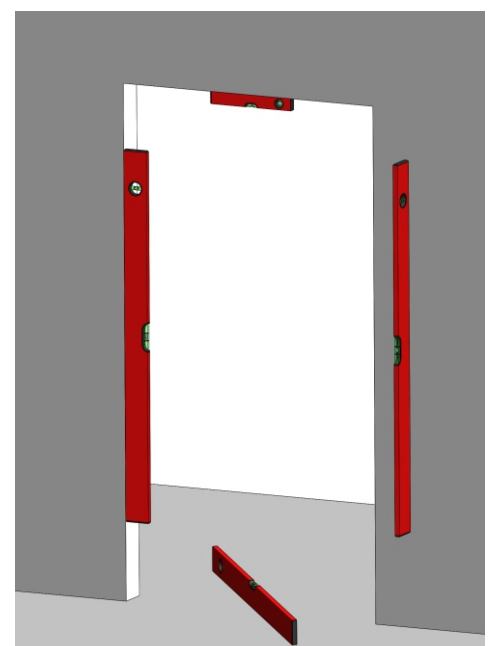

3 INSTALLATION METHODS - MAKE SURE THAT PROPER INSTALLATION MATERIAL IS APPLIED

Steel doors and hatches DFM DS 120-1 and DFM DS 120-2 should be installed in walls of fire rating not less than EI 120 according to EN 13501-2:2016 constructed of cast concrete or reinforced concrete, or of concrete/ reinforced concrete blocks, or of full bricks or aerated brick blocks, , with a thickness of not less than 240 mm and a density of not less than 613 kg / m³.

Door frame should be filled in with plaster type F or A according to EN 520+A1:2012.
Gap between door frame and wall should be tightly filled with mortar, or lime or plaster mortar.

The door frame DFM DS 120-1 and DFM DS 120-2 must be fixed to the wall with steel anchors of at least Ø 10 x 152 mm.

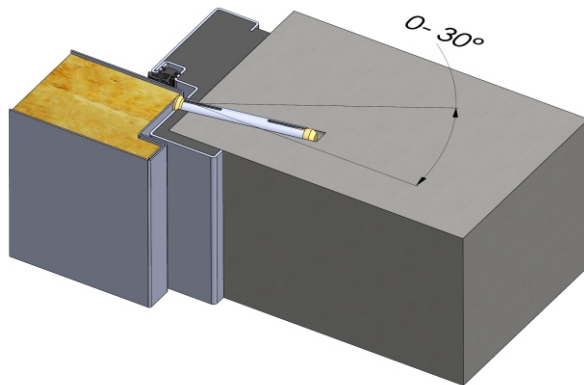

corner frame

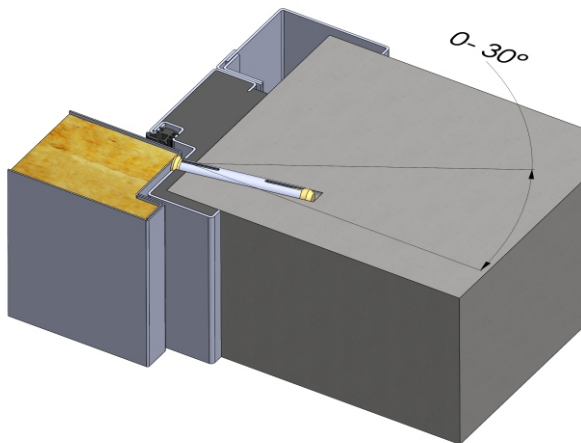

embracing frame

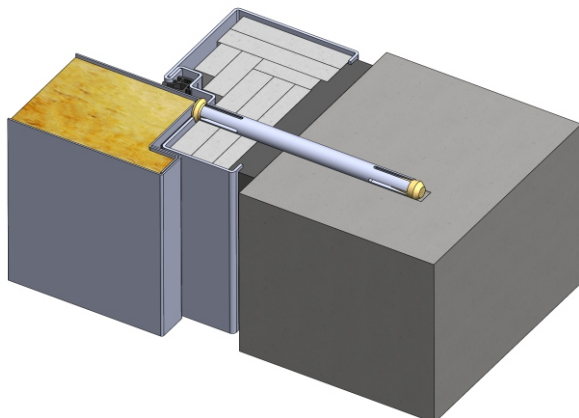

rectangular frame

4 PRELIMINARY ACTIVITIES

Since the weight of the leaves is significant, double-leaf doors are supplied in parts, frame and leaves separately.

Single doors are supplied as a set, frame and leaves together.

4.1 CYLINDER PREASSEMBLING

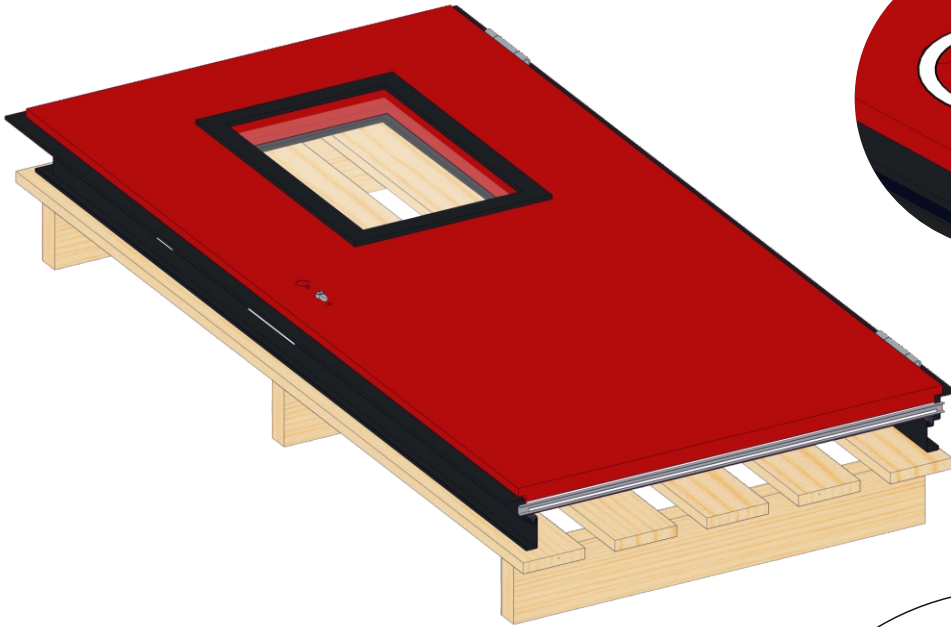

4.2 DISMANTLING OF DOOR LEAF

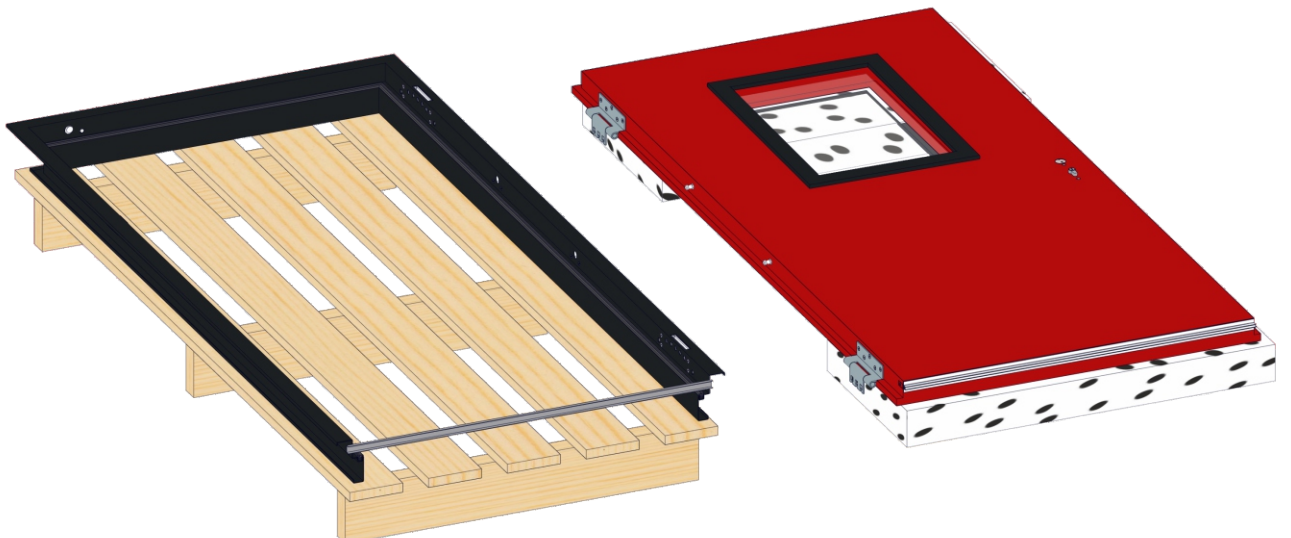

4.3 DISMANTLING TRANSPORTATION BENT PROFILE

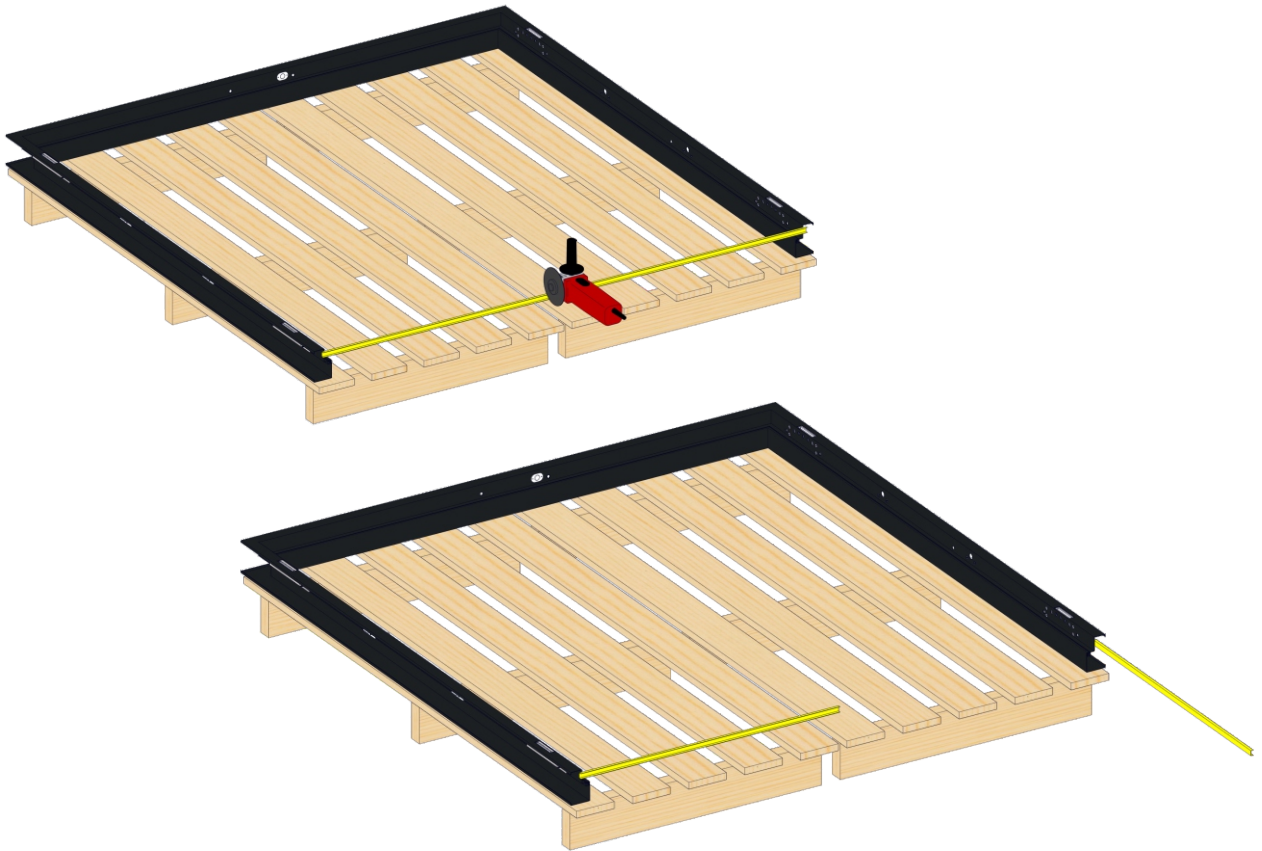

5 PREPARATION OF THE WALL. PREPARE OPENINGS IN THE WALL FOR THE HINGE POCKETS, ANTI-REMOVAL PIN BOXES AND LOCK. AND ALSO FOR THE ELECTRIC LATCH



5.1

BELOW AS AN EXAMPLE OPENINGS FOR CORNER STEEL FRAME (WITH THE ASSUMPTION THAT INSTALLATION GAP IS 7 MM ON HEIGHT AND 11 MM ON EACH SIDE FOR WIDTH). PLEASE NOTE THAT SIZES, GIVEN ON DRAWINGS, ARE ILLUSTRATIVE ONLY, TO BE VERIFIED ON RECEIVED DOORS. CHANGES CAN OCCUR DEPENDING ON PARTICULAR EQUIPMENT OR AS RESULT OF AMENDMENTS OF CONSTRUCTION.

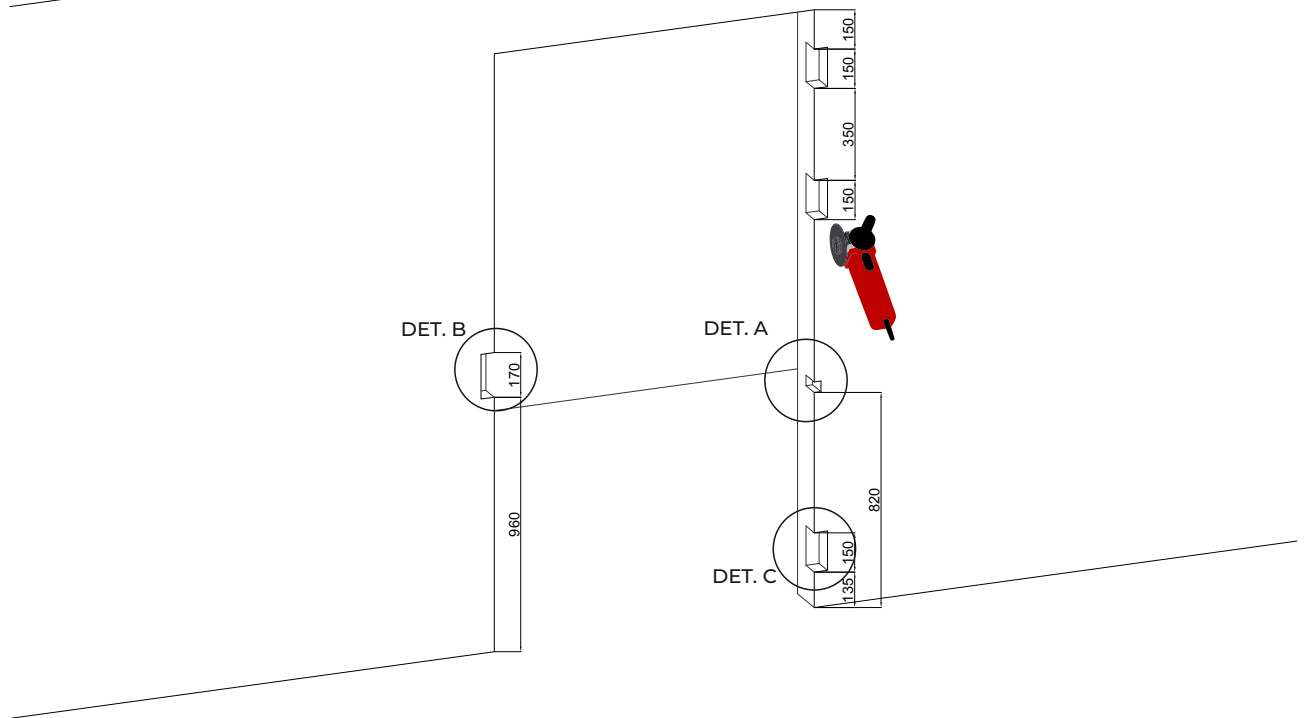
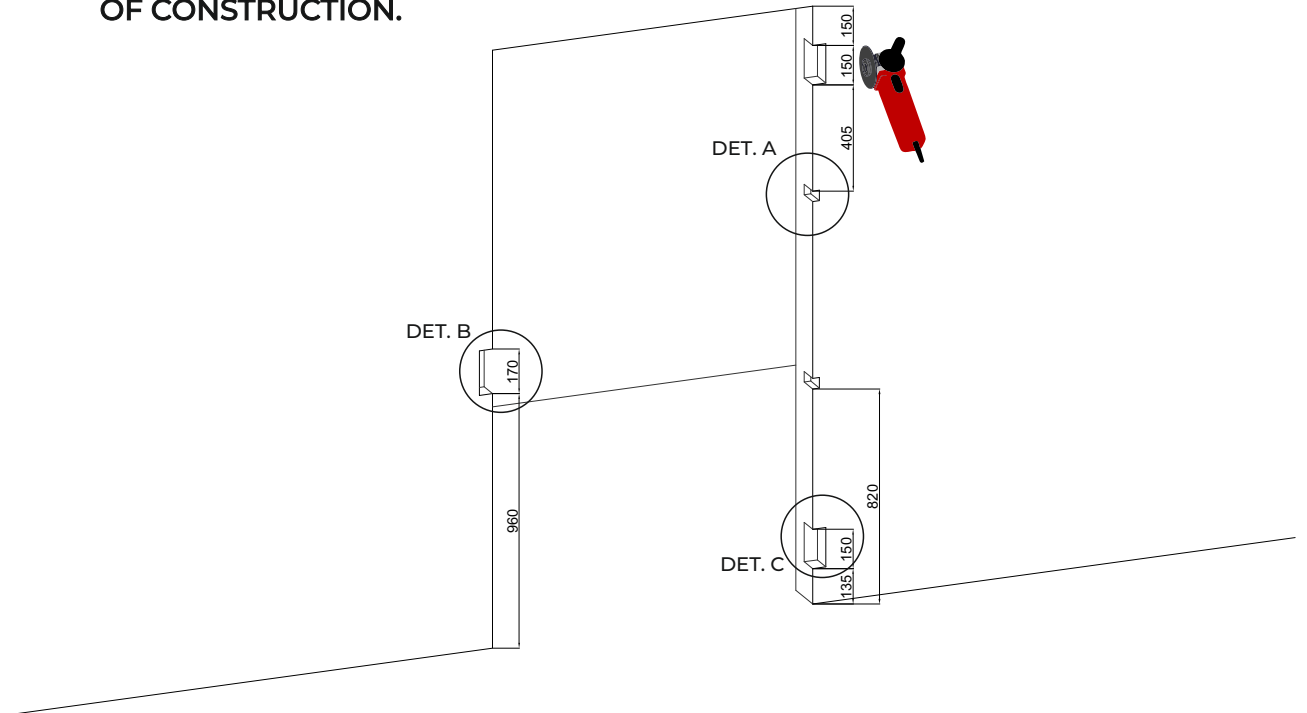

DET. A

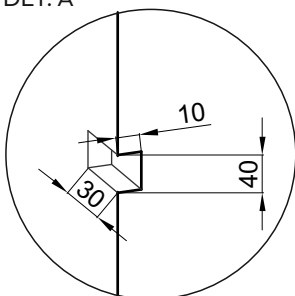

DET. B

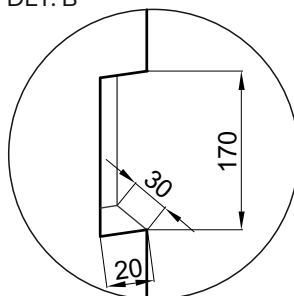

DET. C

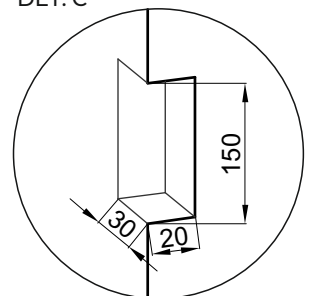

5.2 IF ACCESS CONTROL IS PLANNED, CHECK WHETHER THE CABLE HAS BEEN DISTRIBUTED AT AN APPROPRIATE PLACE.

5.3 FOR EXAMPLE FOR MAGNETIC CONTACT

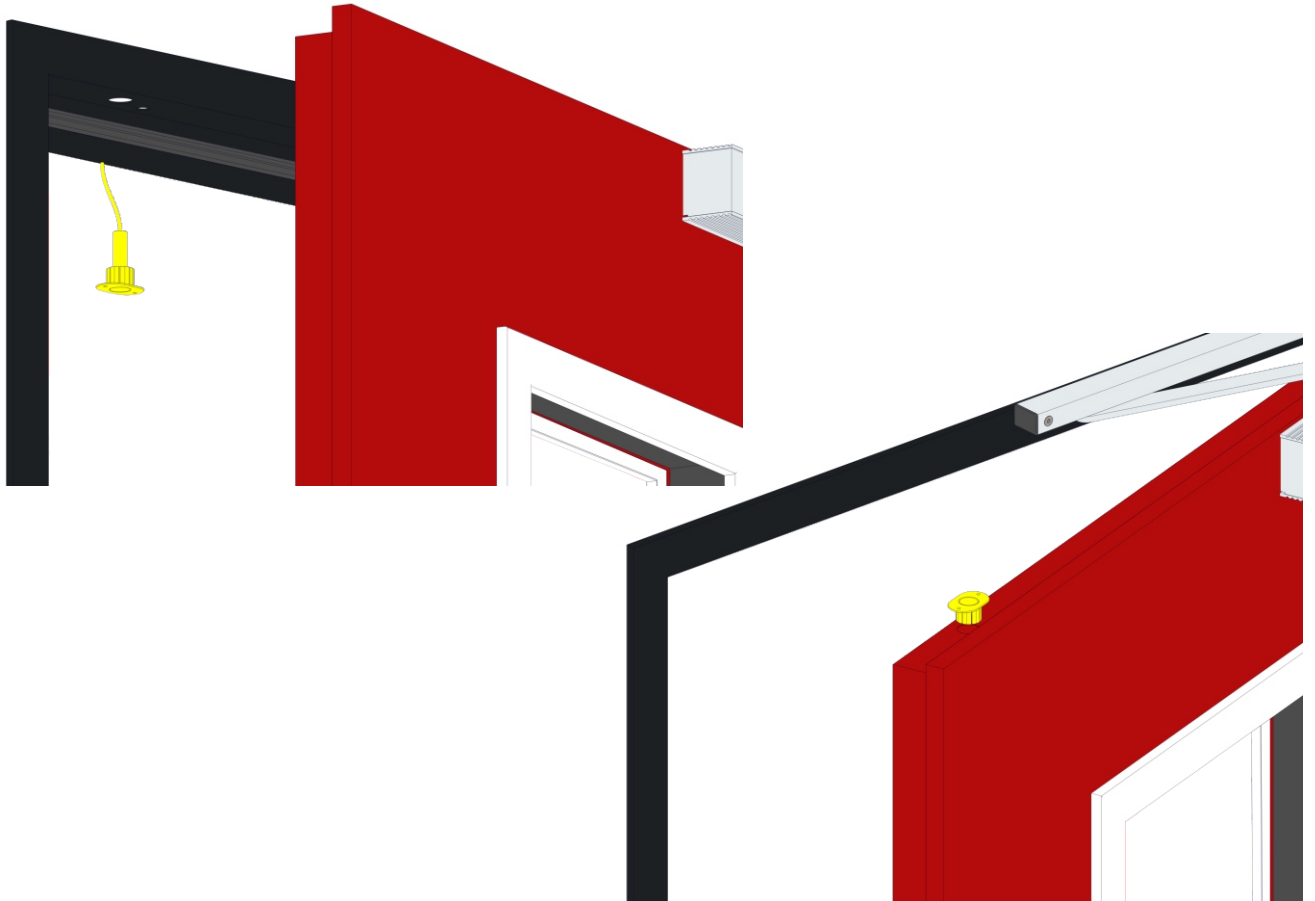

5.4 FOR EXAMPLE FOR ELECTRICAL STRIKE/CABLE CONDUIT

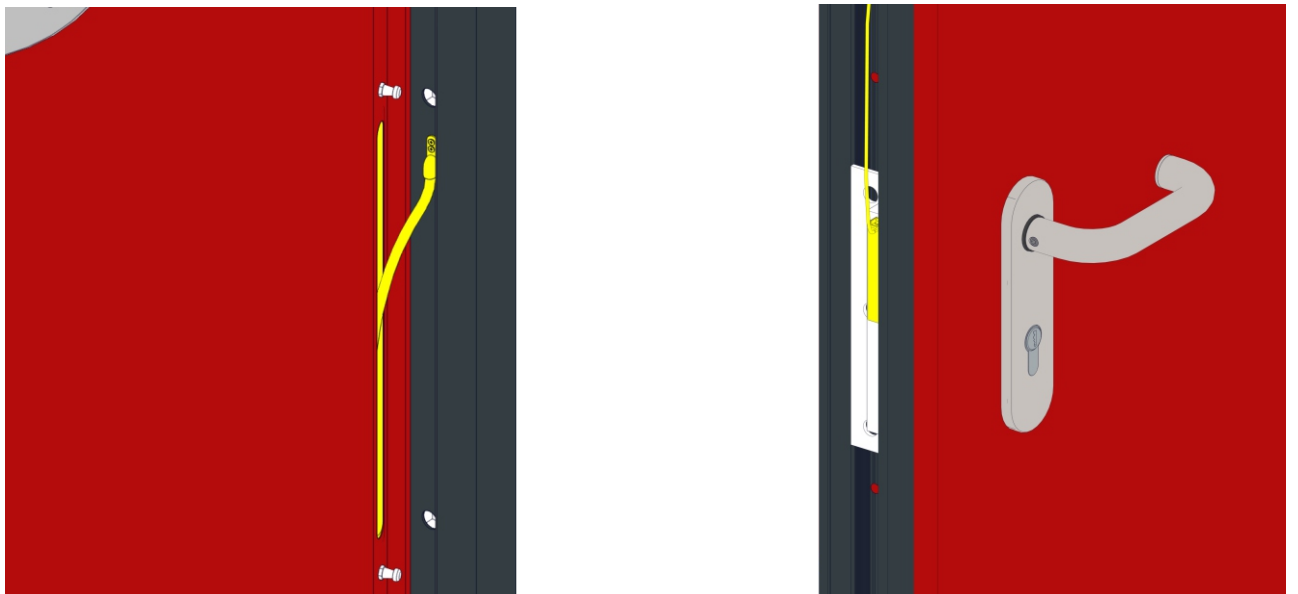

6 FIXING OF THE DOOR FRAME

THE QUANTITY OF ANCHORS DEPENDS ON NUMBER OF FRAME PREPARED HOLES. SCREW OPENINGS ARE PREPARED IN ACCORDANCE WITH RELEVANT CERTIFICATES. .

6.1 VERTICAL PARTS – HINGES SIDE

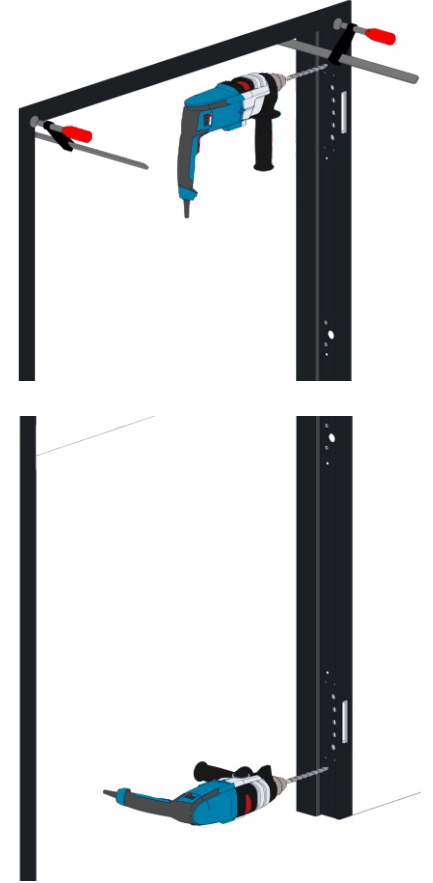
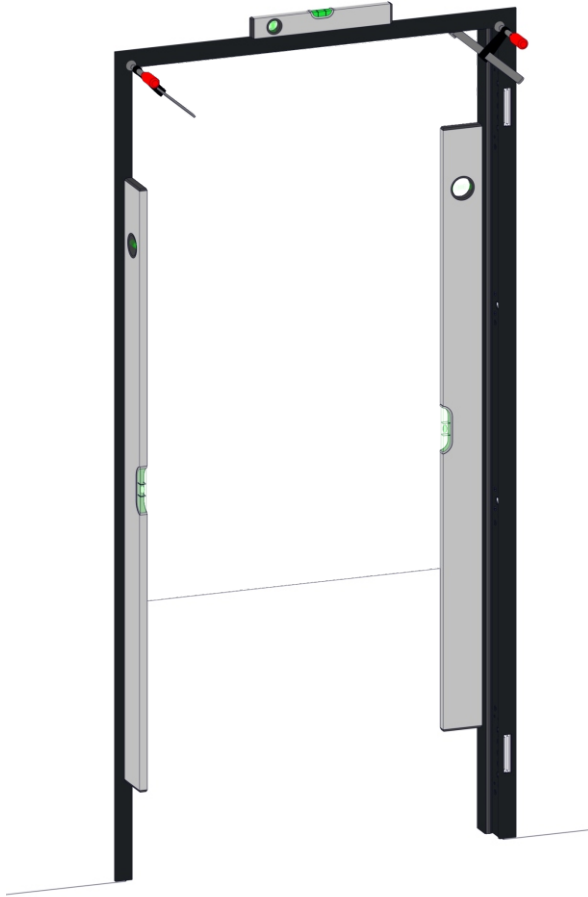

6.2 UPPER PART

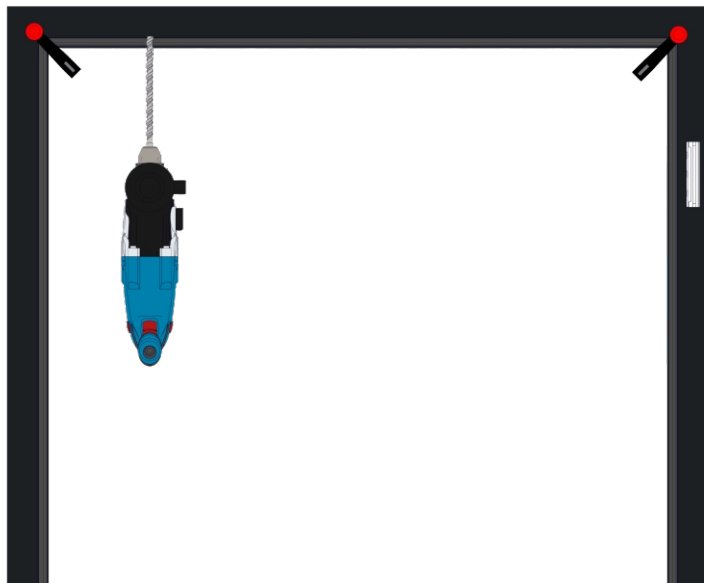

6.3 VERTICAL PART – LOCK SIDE

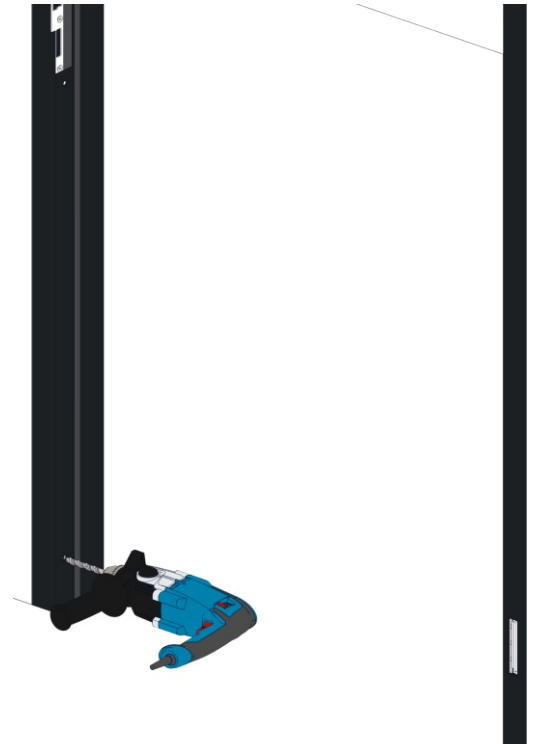

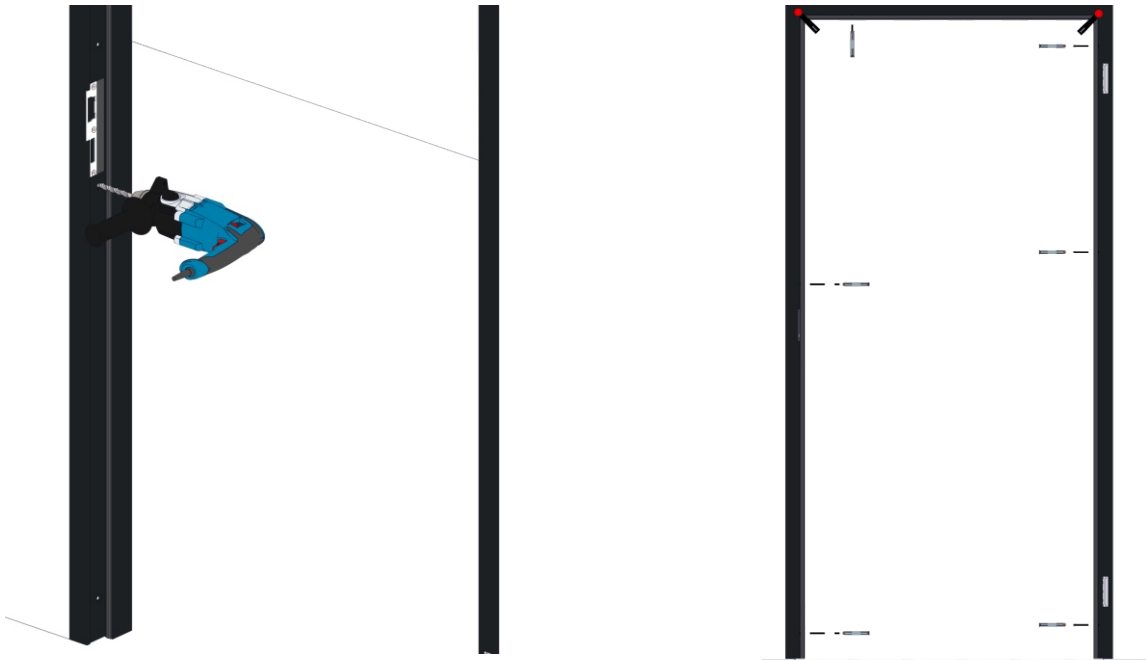

6.4 TIGHTENING ANCHORS WHILE CHECKING THE VERTICAL AND HORIZONTAL LEVEL

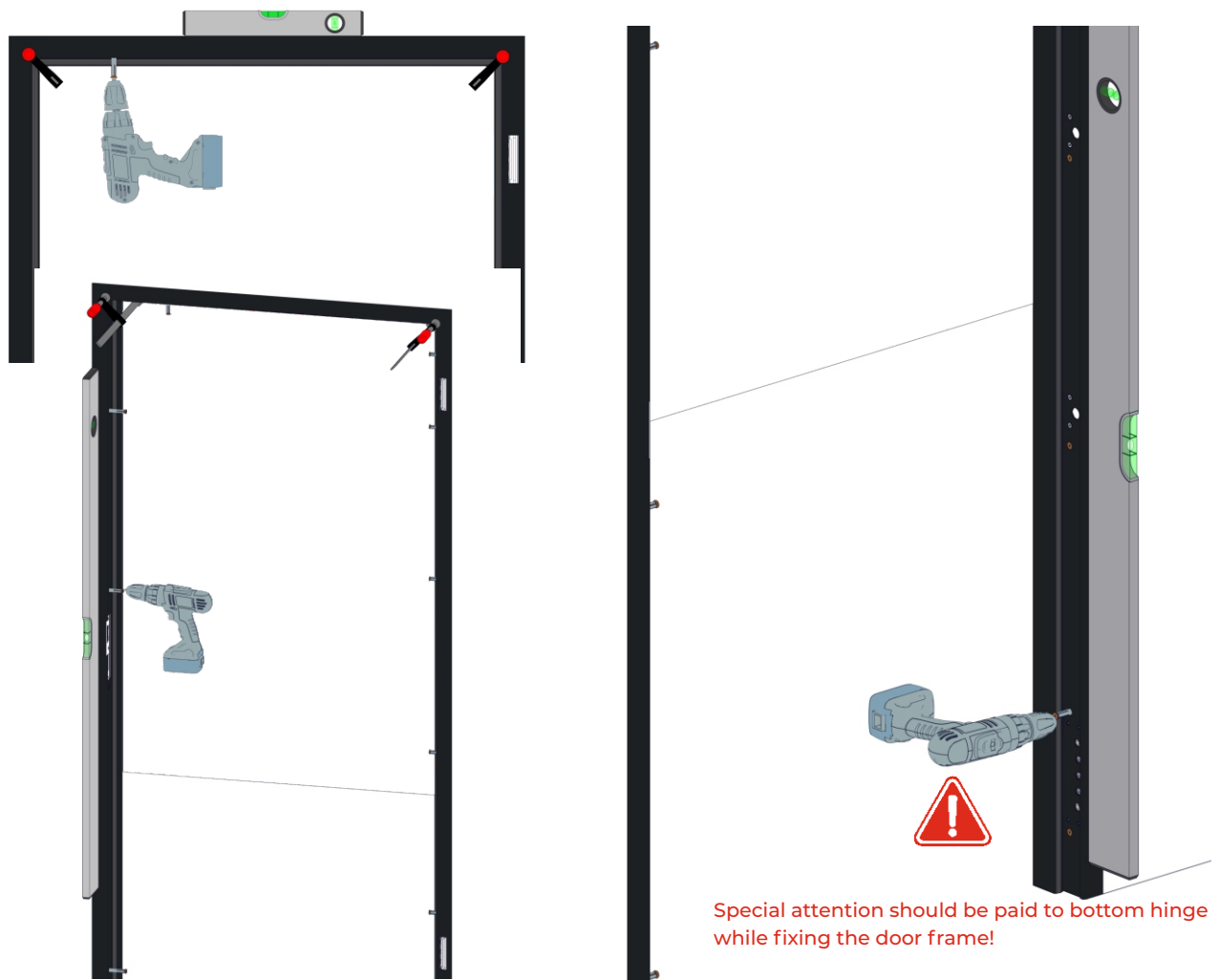

Special attention should be paid to bottom hinge while fixing the door frame!

Box (pocket) of bottom hinge should be fixed rigidly without any twisting of the frame.

6.5 DRILL THE REMAINING HOLES FOR THE ANCHOR IN THE WALL THROUGH THE HOLES PREPARED IN THE BOX. SUPPLEMENT WITH ANCHORS, AT THE SAME TIME CHECK WHETHER THE FRAME IS NOT TWISTED AS „PROPELLER”.

6.6 SEE RESULTS OF INCORRECT INSTALLATION IF THE DOOR FRAME IS NOT FIXED PROPERLY AND RIGIDLY IN THE BEGINNING

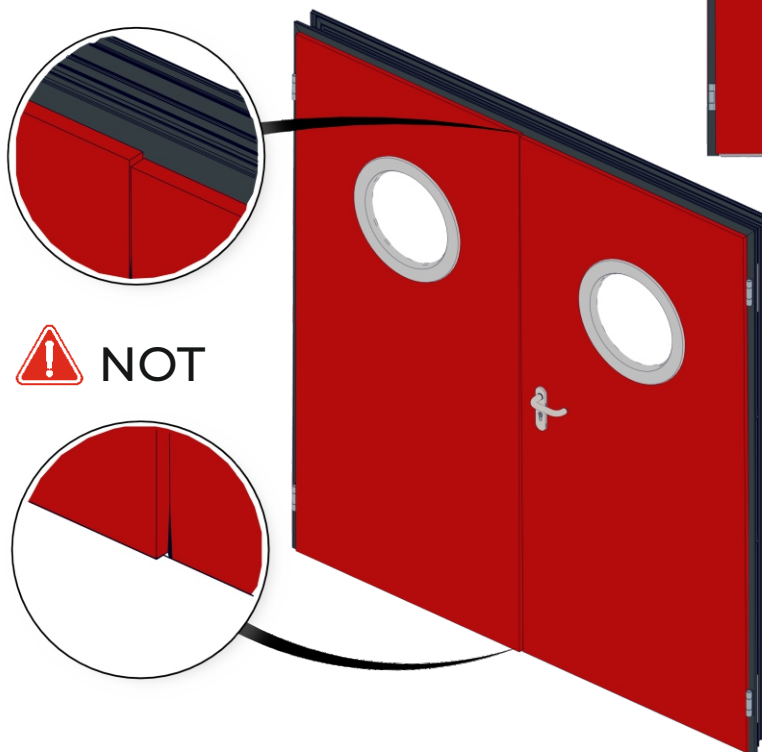
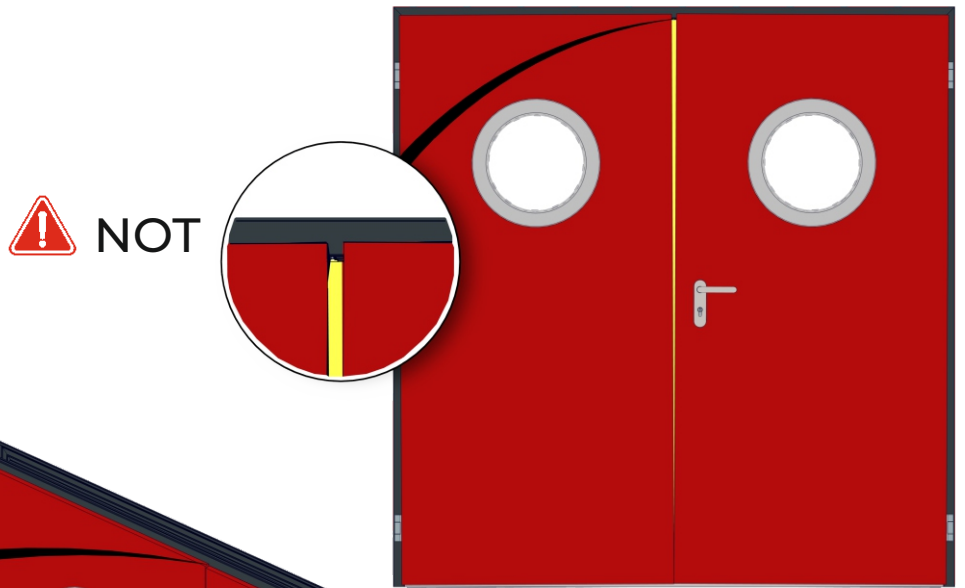
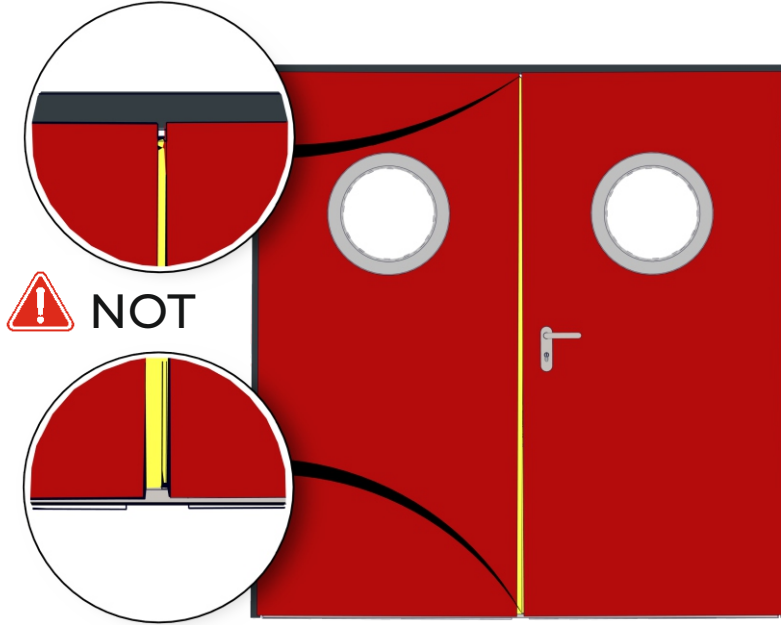

7 ASSEMBLING THE DOOR LEAF AND ITS ADJUSTMENT

7.1 GET LEAF/LEAVES INSIDE TO THE FRAME. PRELIMINARY TIGHT SCREWS

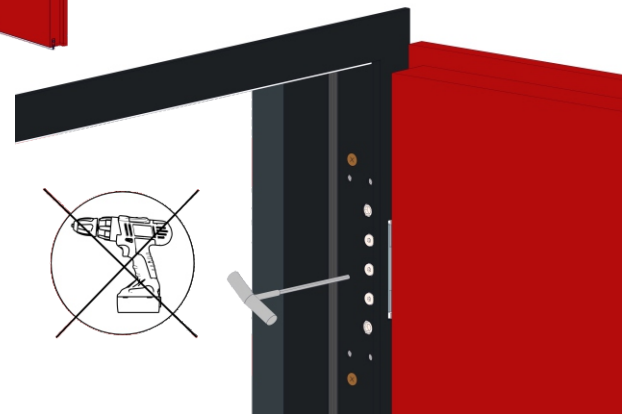

7.2 INSTALL HANDLE AND/OR PANIC BAR

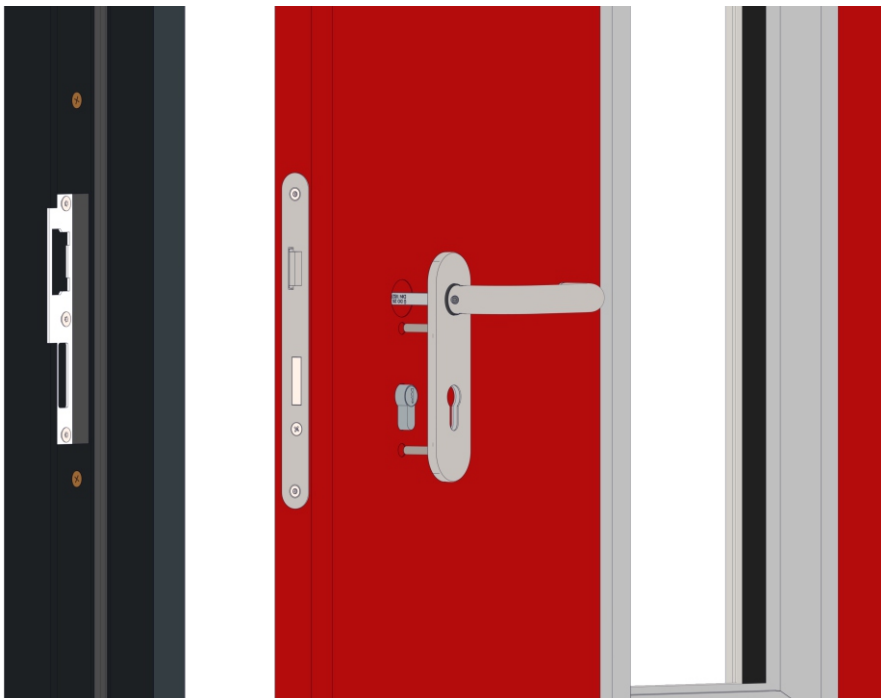

7.3 METHOD OF ADJUSTMENT 3D HINGES

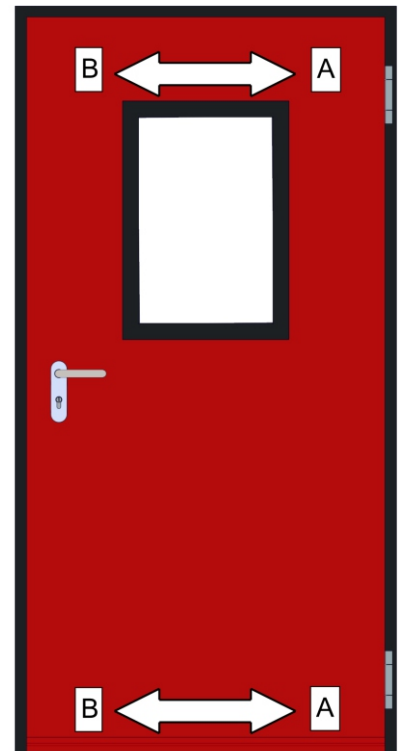
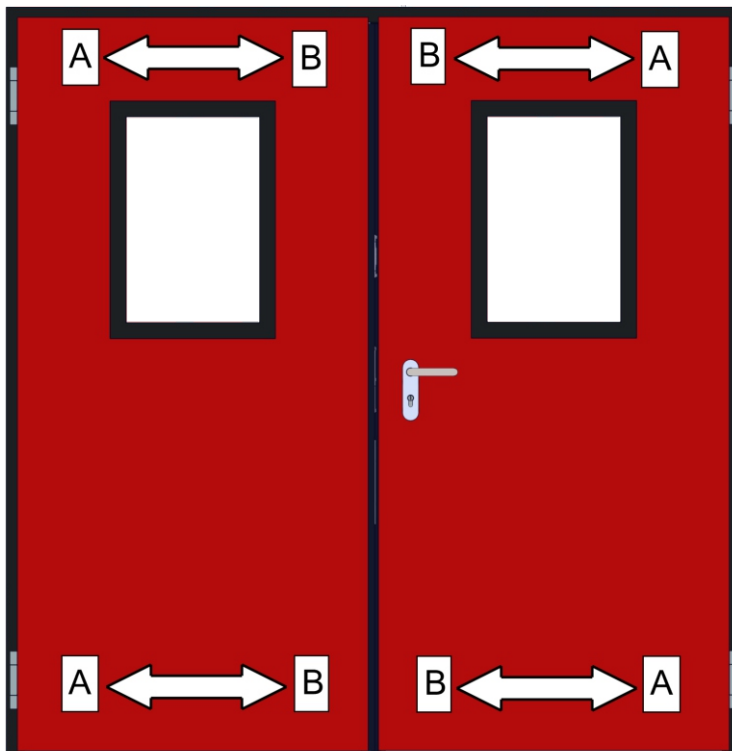
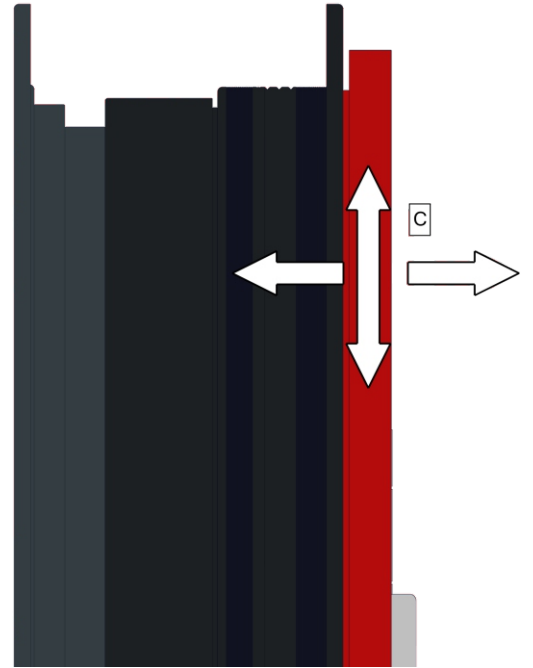
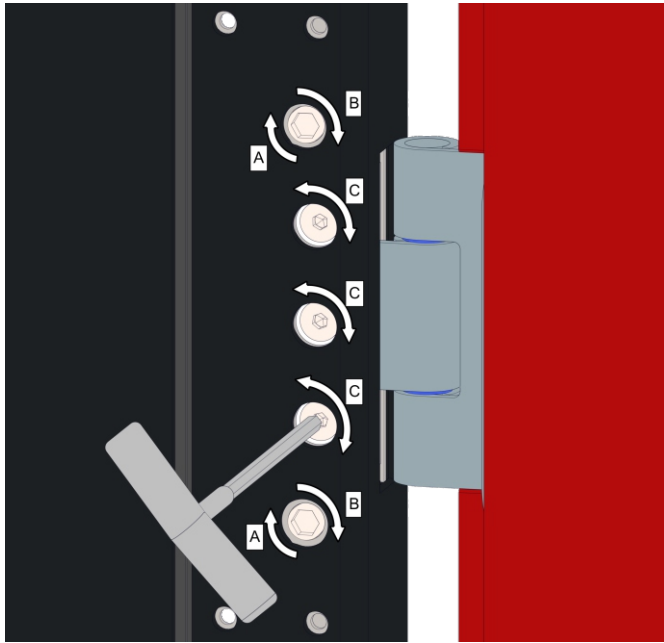

- 7.4** IN ORDER TO AVOID BENDING / BREAKING OF THE PASSIVE LEAF, FLOOR SLEEVE FOR FLUSH BOLT SHOULD BE INSTALLED IMMEDIATELY AFTER ADJUSTING THE POSITION OF THE LEAF.

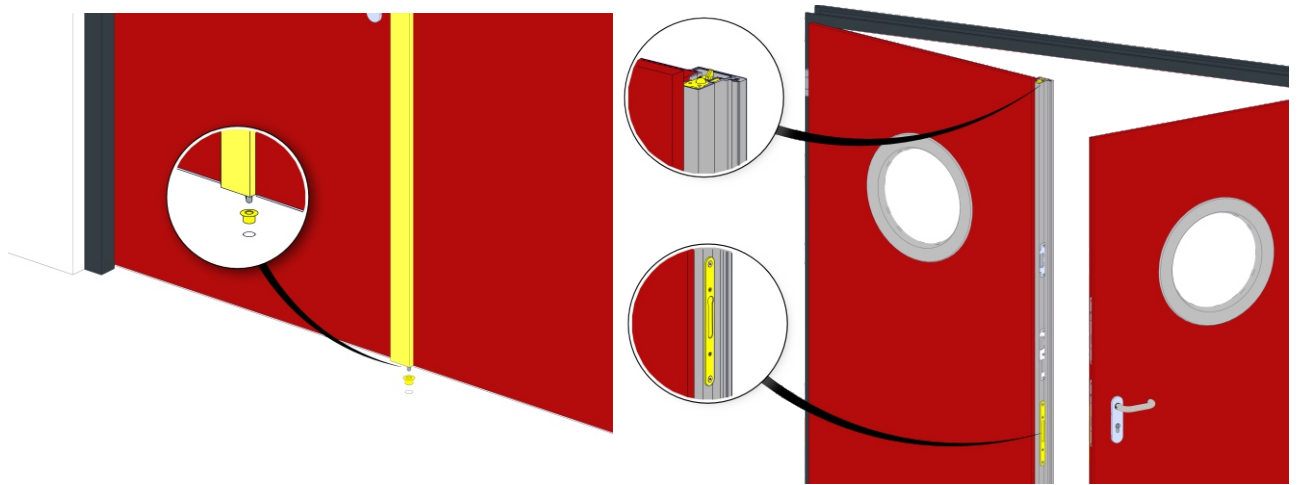

- 8** FILLING THE INSTALLATION GAP - MORTAR

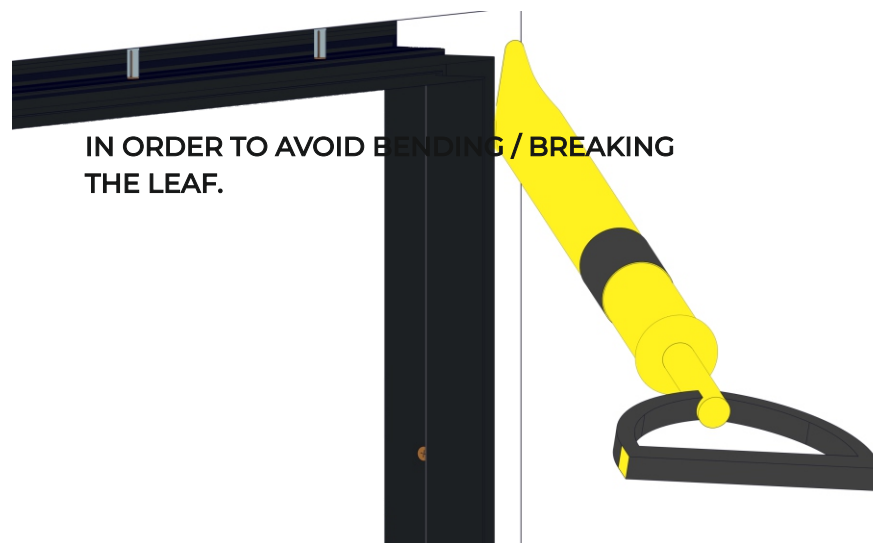

- 8.1** GLUEING FIRE RESISTANT INTUMESCENT GASKET

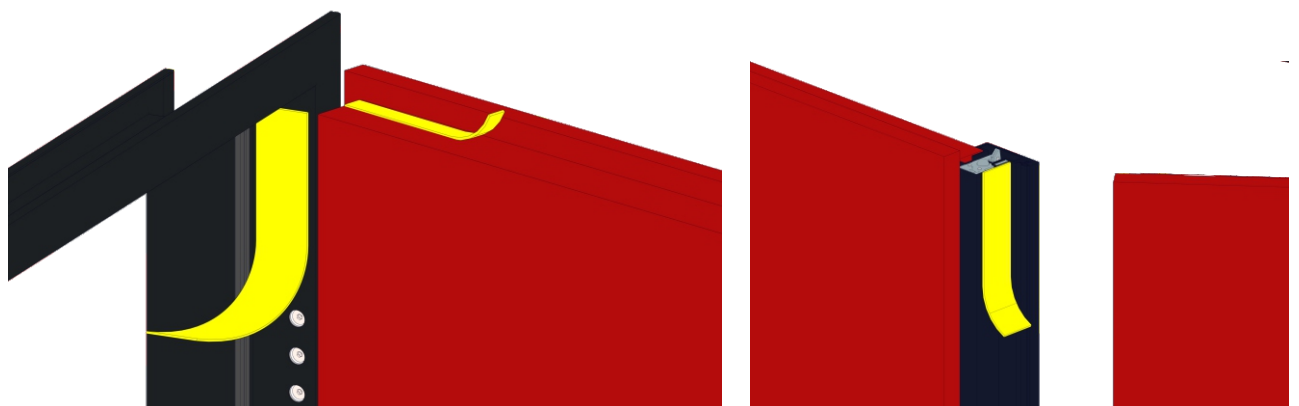

9 OPTIONAL EQUIPMENT

9.1 ELECTRICAL STRIKE

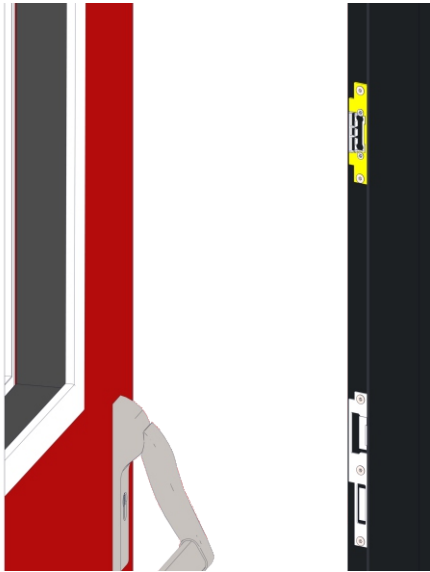

9.2 SYSTEM ANTIPANIC DEVICE
Eco Schulte GBS+EPN900

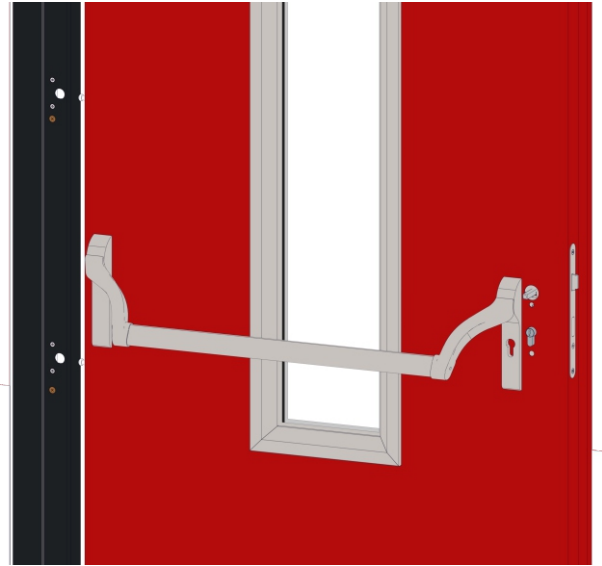

9.3 EMBRACING ELEMENT

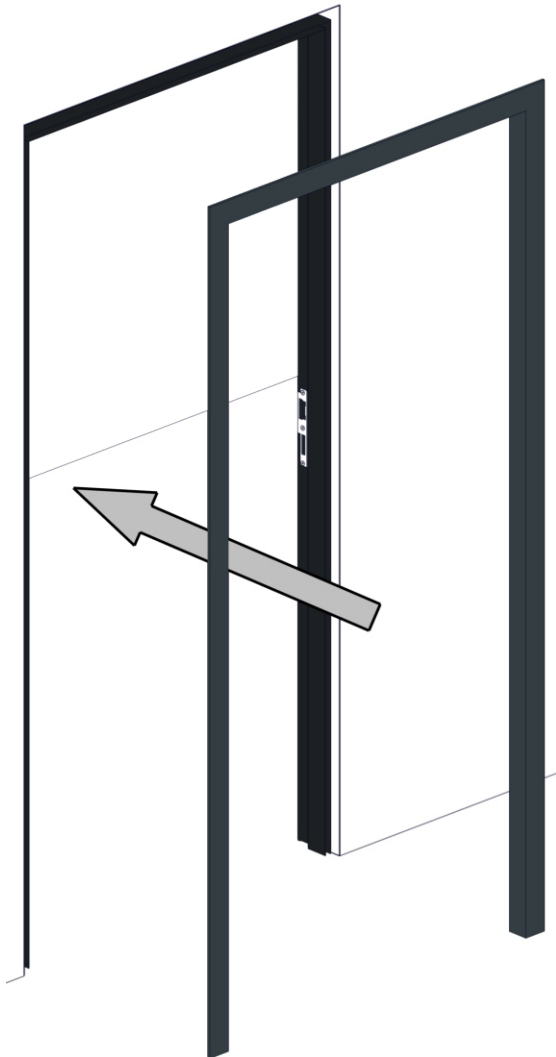

9.4 REGULATION OF AUTOMATIC DROP
DOWN SEAL

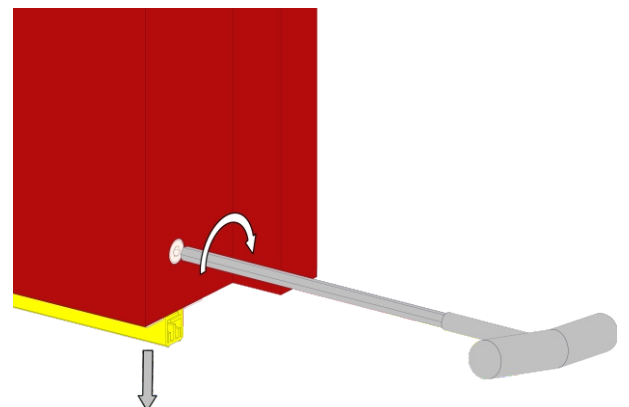

9.5 DOOR LEAF COORDINATOR FOR DOUBLE LEAF DOORS

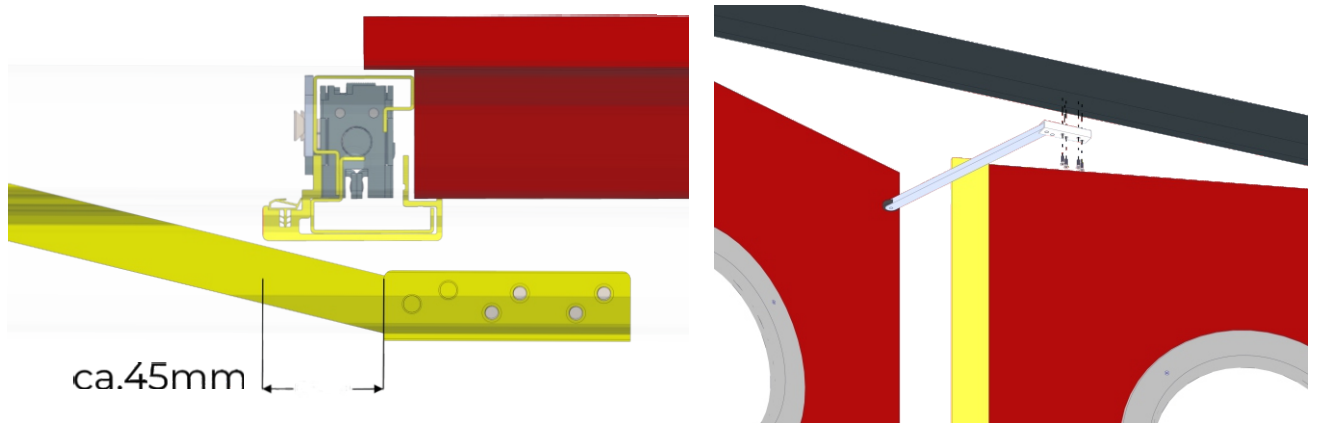

9.6 UPPER DRIP CAP

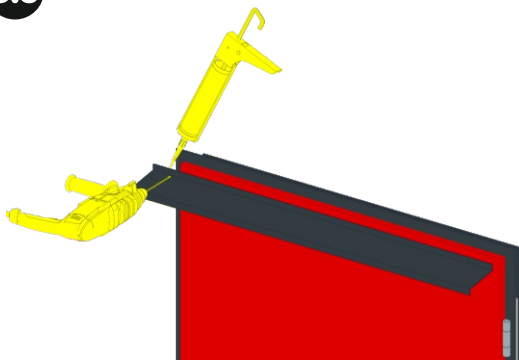

9.7 BOTTOM DRIP CAP

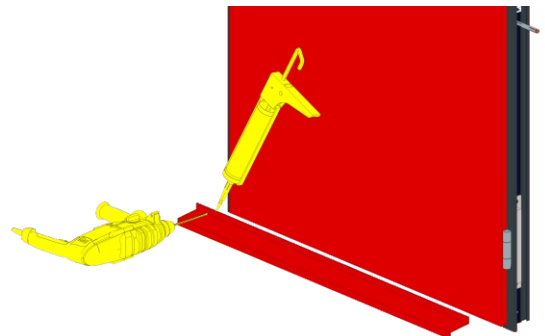

9.8 DOOR CLOSER ECO SCHULTE OR DORMA MOUNTING ACCORRDING PRODUCERS MANUAL

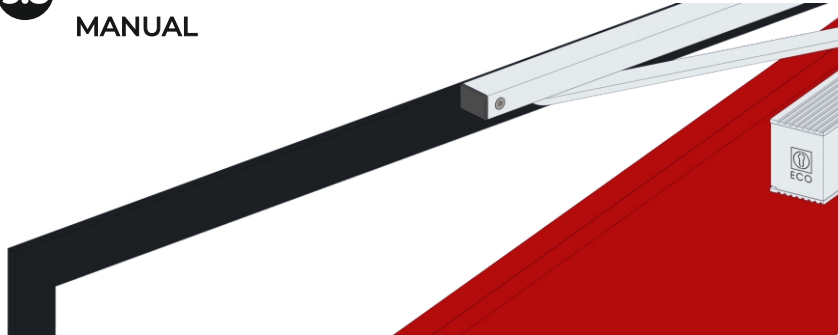

10 THE FILM SHOULD BE REMOVED FROM THE LEAF IMMEDIATELY AFTER INSTALLATION

11 WARRANTY AND HANDLING

Standard warranty term is 12 months counted from day of delivery agreed upon in Order Confirmation. Warranty for additional equipment, such as door closers, panic bars, electric strike plates and the like may be granted based on separate documents provided by the Producers of this equipment.

Please remember:

- to stock the doors flat in a horizontal position and protect them against rain, sun and mechanical damages;
- to remove protection foil from the door's surface immediately after installation;
- to install the doors acc. to the proper certificate ;
- that DFM EUROPE is not responsible for errors and claims caused from incorrect installation;
- to keep DFM warranty maintain the doors and fittings min. each six months;
- each fault must be repaired immediately;
- do not clean doors and equipment with agressive fluids, it could cause corrosion even on stainless steel elements;

The guarantee of DFM Europe Sp. z o.o is defined in General Conditions of Sale published on dfm-europe.eu, or in Order Confirmation.